

APARTMENT LUXEMBOURG-KIRCHBERG

REF. 9293

2 500 000 €

2 bedroom(s)

134.85m² Area

Energetic Index A

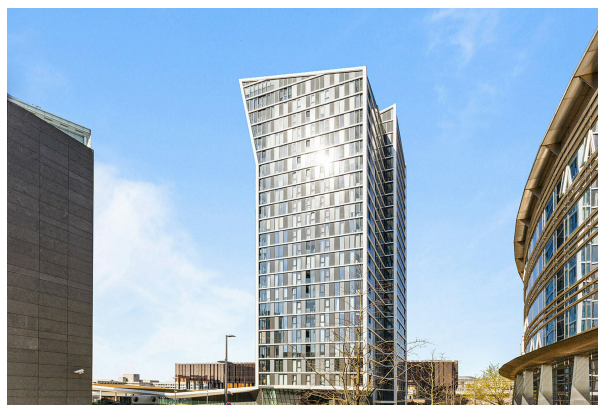

Located in the heart of the Kirchberg district and Luxembourg's business hub, your Unicorn real estate agency is pleased to offer this exceptional apartment for sale. A rare, unique, and one-of-a-kind property.

Located in the Grand Duchy of Luxembourg's first residential tower at the entrance to Kirchberg, close to downtown and offering breathtaking views of the city, this fabulous two-bedroom apartment is full of charming features.

Renovated by an interior designer, this property is nestled on the 22nd floor of the sleek and elegant 25-story tower, designed by world-renowned architect Bernardo Fort-Brescia of Arquitectonica in collaboration with M3 Architects.

Upon entering this apartment with 2.90-meter-high ceilings, you'll discover a contemporary kitchen open to the living area. The space is bathed in natural light through large, triple-glazed windows leading to the terrace-loggia, which can be converted into an 8.59-square-meter winter garden.

Air conditioning in the living area, underfloor heating, and home automation: these modern gems will make your life easier.

The sleeping area features two en-suite bedrooms, each with a full bathroom including a bathtub and walk-in shower. High-end bathroom fixtures.

A storage unit and a private concierge service are also included.

Two parking spaces with electric charging stations are available for an additional €90,000.

Located in the heart of the business district and just steps away from the Philharmonie, the Mudam, and the Grand Théâtre, this tower is set in an ideal urban setting. The project combines three key elements: LIVING, SHOPPING, and WORKING, not to mention the nearby tram line, which makes your commute to downtown a breeze.

<https://www.loft0692.loft.lu/en/detail-9293-vente-appartement-luxembourg-kirchberg>

loft.lu

18, rue du Marché-aux-Herbes
L-1728 Luxembourg
Grand Duché du Luxembourg

info@loft.lu
www.loft.lu

T. +352 26 54 17 17
T. +352 26 53 25 36